

CHANGES TO THE TECHNICAL RULES

The texts below are applicable from January 1, 2023, unless otherwise indicated.

t.18

Figure 1 - Piste for semi-finals and finals (maximum height 50 cm)

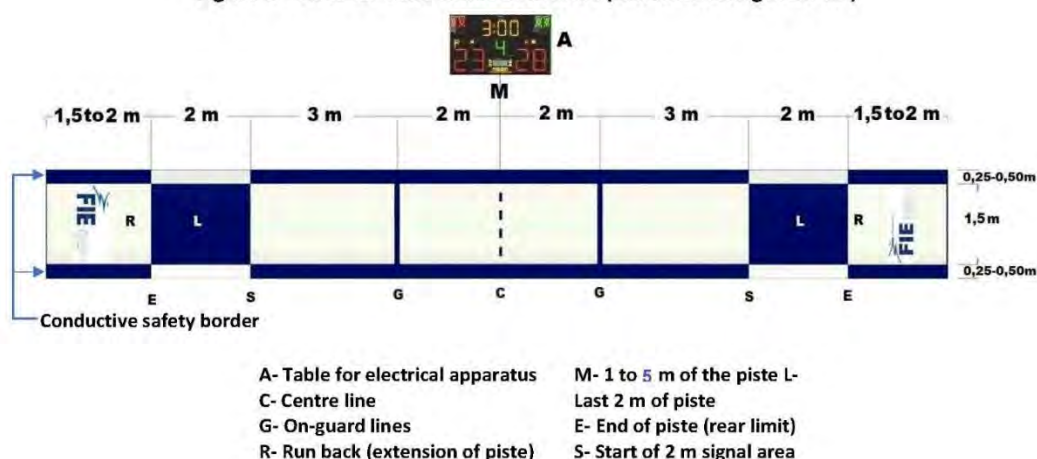

For foil and epee the conductive surface must cover whole of the length and breadth of piste, including its extension (run back) (Cf. Article t.18, m.57)



Figure 2 - Standard piste for all three weapons

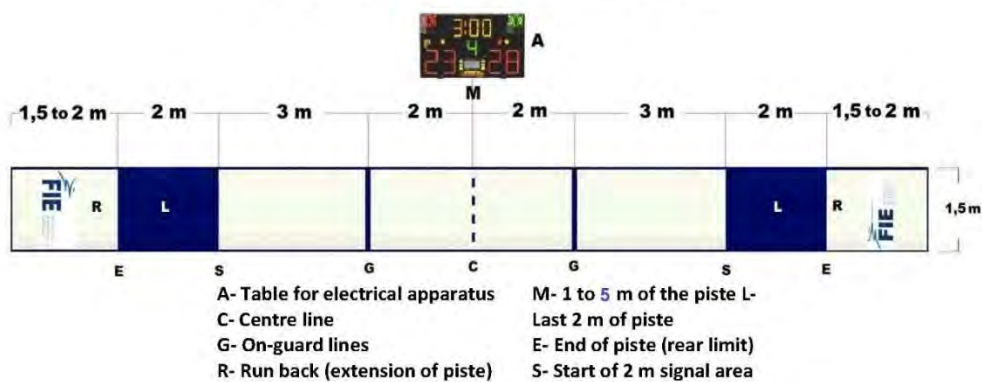

t.18.4

The distance between the score machine table or stand and the edge of the piste should be between 1 meter and ~~4.5~~ 5 meters. ~~Any slave score machine must not be placed nearer than 5 meters from the edge of the runback area.~~

Injuries and other medical reason, withdrawal of a competitor
~~cramp~~ **Injury or other medical reason**, withdrawal of a competitor

t.45

1. For ~~a any sport trauma~~/injury or ~~cramp or other acute medical incident~~ **other medical reason** which occurs in the course of a bout and which is properly attested by the delegate of the FIE Medical Commission or, in ~~his/her~~ absence, by the doctor ~~and/or medical provider~~ on duty, the Referee will allow a break in the fight lasting no longer than 5 minutes. **Only the doctor and/or medical provider on duty can determine the length of time of treatment required when a medical time-out is granted.** This break should be timed from the point when the delegate of the FIE Medical commission or, in his absence, the doctor gave his opinion. This break should be strictly reserved for the requisite treatment. If the delegate of the FIE Medical Commission or, in his absence, the doctor on duty considers, before or at the end of the 5 minute break, that the fencer is incapable of continuing the fight, ~~he/she~~ will decide that the fencer should retire (individual events) and/or be replaced, if possible (team events) (cf. o.99.6.a/b).

If the athlete retires and a medical withdrawal is determined, the FIE Medical delegate or, in his/her absence, the doctor or medical provider on duty must fully complete the FIE Medical Withdrawal form and submit it to the Directoire Technique for its inclusion into the FIE supervisor's final report.

All breaks for a ~~sport trauma, cramp, or an acute medical incident~~ **medical reason** must be noted on the score-sheet for the bout, the pool or the match.

2. During the remainder of the same day, a fencer cannot be allowed a further break unless as a result of a different injury ~~or other or cramp or acute medical incident~~ **medical reason**.
-

t.47

2 ~~The Referee has many~~ Duties **of referees**:

- a) ~~He~~ **The Referee** calls the roll of the competitors (cf. t.114, t.118, t.119).
- b) ~~He~~ **The Referee** directs the bout.
- c) Before each bout, ~~he~~ **the Referee** must check the weapons, clothes and equipment of the fencers, according to the regulations below.
- d) ~~He~~ **The Referee** superintends the proper functioning of the electrical apparatus. Either on ~~his~~ own initiative or when asked to do so by a team captain or competitor, ~~he~~ **the Referee** implements tests necessary to check the apparatus and locate any faults which may be found. ~~He~~ **the Referee** will prevent the competitors from hindering the tests by unplugging or changing their equipment prematurely.
- e) ~~He~~ **The Referee** directs the judges, time-keepers, scorers, etc.
- f) ~~He~~ **The Referee** positions himself and moves in such a way as to be able to follow the bout while always being able to see the illumination of the signal lamps.

g) ~~He~~ The Referee penalises faults (cf. t.164).

h) ~~He~~ The Referee awards the hits (cf. t. 54ss).

i) ~~He~~ The Referee maintains order (cf. t.137).

j) Whenever ~~he considers it~~ necessary, ~~he~~ the Referee should consult the experts concerning the electrical apparatus (cf. o.28).

k) The Referee ~~should~~ **must** also supervise the state of the conductive piste; ~~he and must~~ not allow the bout to commence or to continue if the conductive piste has holes in it which might affect the proper registering of hits.

t.56

10. Hit made during or after a fall must be annulled.

t.63

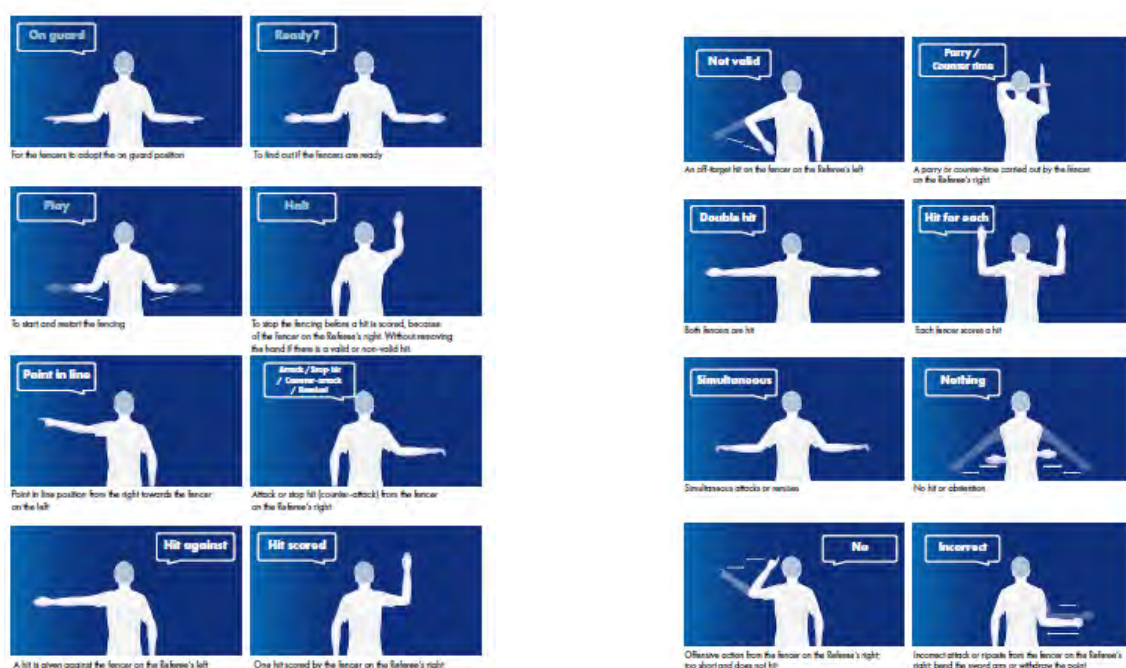

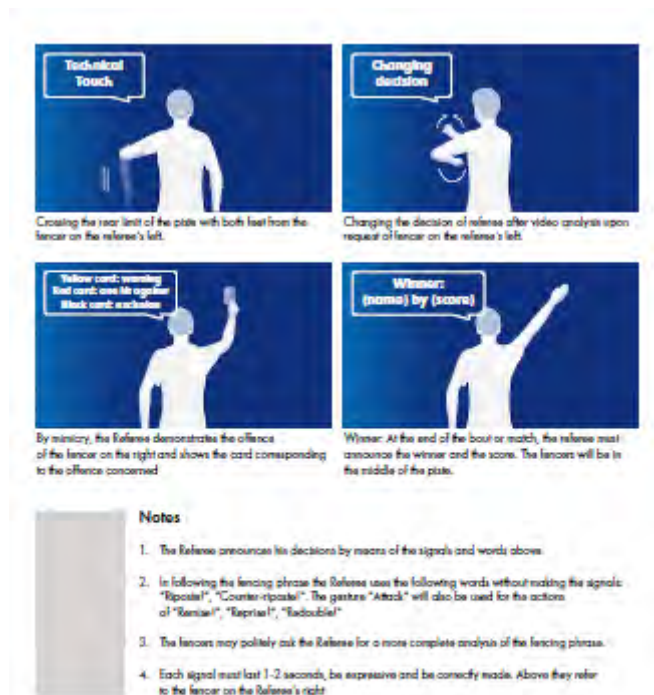

Figure 3 Referee signals and commands

t.121.2

- 2 All bouts must preserve the character of a courteous and frank encounter. All irregular actions (fleche attack which finishes with a collision jostling the opponent, disorderly fencing, irregular movements on the piste, hits achieved with violence, blows struck with the guard, ~~hits made during or after an intentional fall down to avoid the touch~~) or anti-sporting behaviour are strictly forbidden (cf. t.158-162, t.170). Should such an offence occur, any hit scored by the fencer at fault is annulled.

t.124

Unwillingness to fight (Non-combativity)

There is unwillingness to fight when there is one minute of fencing without a hit or without a hit scored off the target.

~~When one or both fencers make clear their~~In the event of unwillingness to fight, the Referee will immediately call 'Halt!' as a decision of "fact" (cf.t.136.2).

Unwillingness to fight is sanctioned as follows:

0.5	Unwillingness to fight: the sanctions imposed are shown by specific P- cards which are not cumulative with any other sanction awarded.	t.124	1 st time P-Yellow	2 nd and 3 rd times P-Red	From 3 rd 4 th time Penalisation
-----	--	-------	----------------------------------	--	---

1 Individual events – Direct elimination

P-yellow cards and P-red Cards are awarded ~~to each fencer separately~~ to both fencers simultaneously, starting with a P-Yellow card, followed by ~~two~~ a P-Red cards ~~s and finally by a~~ The P-Black card is awarded as described in 1c) below.

a) When, for the first time, there is one minute of unwillingness to fight, the Referee sanctions ~~one or~~ both fencers with a P-yellow card. ~~as follows:~~

- ~~a) If the fencers are equal: the Referee sanctions both fencers with a P-yellow card.~~
- ~~b) If the fencers are not equal: the Referee sanctions the fencer who has the lower score with a P-yellow card.~~

b) When, for the second ~~and third~~ times, there is one minute of unwillingness to fight, the Referee sanctions ~~one or~~ both fencers with a P-red card. ~~as follows:~~

~~If the fencers are equal: the Referee sanctions both fencers with a P-red card.~~
~~If the fencers are not equal: the Referee sanctions the fencer who has the lower score with a P-red card.~~

c) When, ~~for from~~ the ~~fourth~~ third time, there is one minute of unwillingness to fight, a P-black card is awarded as follows: ~~one or both fencers who have already received two P-red cards, receive a P-black card~~

ie) If the scores of the two fencers ~~receive P-Black cards simultaneously and their scores~~ are equal, the Referee sanctions the fencer with the lower initial seeding in the competition, which is based on the FIE ranking, with a P-Black card. ~~T~~he fencer with the higher initial seeding in the competition, which is based on the FIE ranking, wins the bout.

ii) If the scores of the two fencers ~~receive P-Black cards simultaneously, and their scores~~ are not equal, the Referee sanctions the fencer with the lower score with a P-Black card. ~~T~~he fencer with the higher score wins the bout.

2 Team events

P-Yellow, ~~and~~ P-Red cards are awarded to the two ~~each~~ teams ~~separately simultaneously~~, starting with a P-Yellow card and followed by ~~two~~ a P-Red cards. The P-Black card is awarded ~~to the fencer~~ as described in 2c) below.

a) When, for the first time, there is one minute of unwillingness to fight, the Referee sanctions ~~one or~~ both teams with a P-yellow card. ~~as follows:~~

- ~~a) If the teams are equal: the Referee sanctions both teams with a P-yellow card.~~
- ~~b) If the teams are not equal: the Referee sanctions the team with the lower score with a P-yellow card.~~

b) When, for the second ~~and third~~ times, there is one minute of unwillingness to fight, the Referee sanctions ~~one or~~ both teams with a P-red card. ~~as follows:~~

~~c) If the teams are equal: the Referee sanctions both teams with a P-red card.~~

~~d) If the teams are not equal: the Referee sanctions the team which has the lower score with a P-red card.~~

c) When, ~~for~~^{from} the ~~fourth~~^{third} time, there is ~~one minute of~~ unwillingness to fight, a P-Black card is ~~awarded as follows: given to the fencer on the piste of either or both teams which have already received two P-red cards.~~

i) If the scores for the two teams are equal, the Referee sanctions the team with the lower initial seeding in the competition, which is based on the FIE ranking, with a P-Black card. The team with the higher initial seeding in the competition, which is based on the FIE ranking, wins the match.

ii) If the scores for the two teams are not equal, the Referee sanctions the team with the lower score with a P-Black card. The team with the higher score wins the match.

~~e) A team in which a fencer has received a P-black card may use their reserve fencer, if they have one and if the replacement has not already been made previously for tactical or medical reasons. If a replacement is made following receipt of a P-black card, no further replacement may be made, even for medical reasons.~~

~~If no replacement can be made following receipt of a P-black card (because there is no reserve fencer or because the reserve fencer has already been used previously), the team in which a fencer has been sanctioned by a P-black card loses the match.~~

~~Following the replacement of a fencer after the awarding of a P-Black card, the relay in question continues. Any further occurrence of unwillingness to fight results in a further P-Black card and the team in question loses the match.~~

~~f) If a P-Black card is given to the fencers on the piste in both teams simultaneously and neither of the teams can make a replacement and their scores are equal, the team with the higher initial seeding in the competition, which is based on the FIE ranking, wins the match.~~

~~g) If a P-Black card is given to the fencers on the piste in both teams simultaneously and neither of the teams can make a replacement and their scores are not equal, the team with the higher score wins the match.~~

3 In both individual and team competitions

~~In case of unwillingness to fight, it is up to the referee to call "Halt" as a decision of fact (cf. t.136.2).~~

a) The P-yellow (warning), P-red (penalty hit) and P-black (the possible losing of a bout or match) cards received during any one bout or match (during all 9 relays) are valid only for that bout or match. They are not transferable to the following bout or match.

No P-card (yellow, red or black) may be awarded in individual competitions at 14-14 or in team matches at 44-44.

b) In both individual and team competitions, fencers and teams who have lost the bout/match following the award of a P-Black card, will be ranked in the final results of the competition as having lost the bout/match. They receive the corresponding points.

c) In both individual and team competitions, the period/relay continues after the awarding of a P-Yellow or a P-Red card.

d) The minute starts again after each hit, each hit off the target, each hit annulled, each penalty hit and at the beginning of each period or relay.

e) The referee must record these P-yellow, P-red and P-black cards separately on the score sheet. The sanctions awarded for unwillingness to fight are not cumulative with any other sanction awarded.

f) In both individual and team competitions, if, at the end of the regulation time, there is equality of scores, article t.124 does not apply and articles t.40.3 and t.41.5 will apply.

t.170

0.5	Unwillingness to fight: the sanctions imposed are shown by specific P- cards which are not cumulative with any other sanction awarded.	t.124	1 st time P-Yellow	2 nd and 3 rd times P-Red	From 3 rd 4 th time Penalisation
-----	--	-------	----------------------------------	--	---

	2nd group		1st offence	2nd offence	3rd offence and subseq.
2.1	Use of non-sword arm/hand (*)	t.29.1. t.30	RED	RED	RED
2.2	Demanding a break for claimed injury/cramp medical reason deemed unjustified by doctor	t.45.3			
2.3	Absence of weapon control marks (*)	t.73.1.a			
2.4	-				
2.5	Deliberate hit not on opponent (*)	t.55.3			
2.6	Dangerous, violent or vindictive action, blow with guard or pommel (*)	t.121.2 ; t.147 ; t.149.1			